

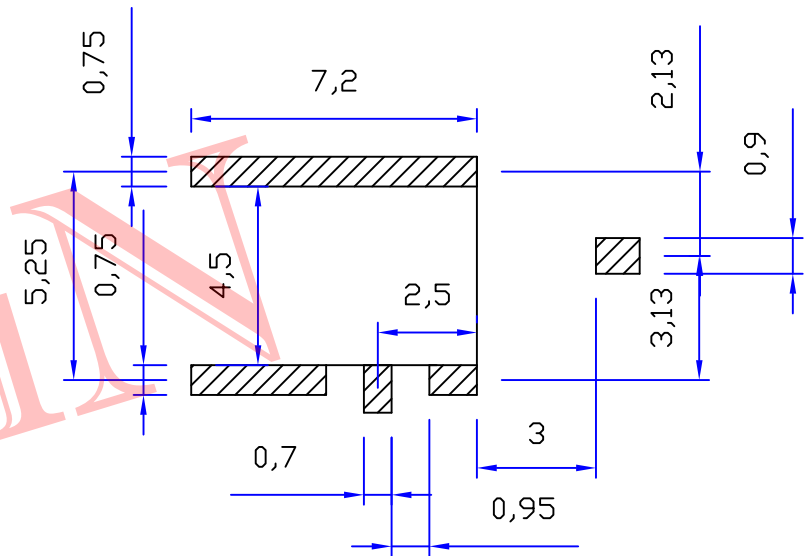

Product NO.		DOSIN-809-0045		
REV	DESCRIPTION	DWN	DATE	APPROVEN
A	First issue	Mr. Wang	2015/12/24	John kine
B				

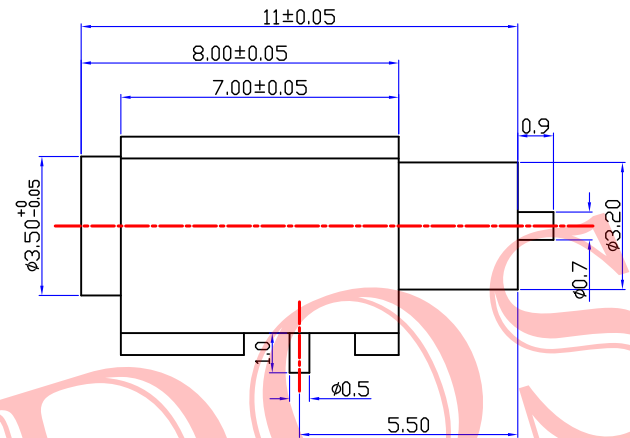
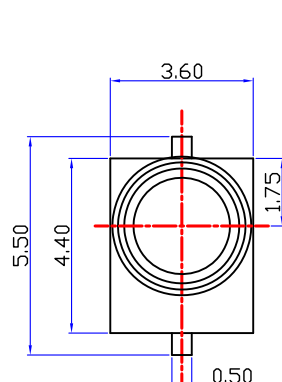

1. Electrical Characteristics
  - 1.1 Impedance: 50 Ohm
  - 1.2 Working Frequency: DC - 3 GHz
  - 1.3 S.W.R. :  $\leq 1.5$
  - 1.4 Working Voltage: 335V / max
  - 1.5 Insulation Resistance: 1000 Mohm
  - 1.6 Contact Resistance: Center Contact: 5 mohm
  - 1.7 Outer Contact:  $\leq 2.5$  mohm
2. Environmental
  - 2.1 Working Temperature Range:  $-55^{\circ}\text{C} \sim +125^{\circ}\text{C}$
3. With the male head to turn off, not to plug conduction

RECOMMENDED PCB LAYOUT

NOTE:	Tolerance	X. $\pm 0.15$ X.X $\pm 0.10$ X.XX $\pm 0.05$ Angular $\pm 5^{\circ}$
DRAWN Zelin. Zhang	View	
CHECKED	UNIT	MM
APPROVALS John Kine	SCALE	1:1

<b>Dosin Industrial (HK) Co Ltd</b> 东莞市德索五金电子制品有限公司 <b>Dosin Hardware Electronics Co., Ltd</b>		E-mail: dosin2005@163.com dosin2005@dosin-china.com Web: http://www.dosinconn.com TEL: (0086) 769-81153906 FAX: (0086) 769-81875836	
Name: <b>MMCX P.C.B JACK</b>			
SIZE A	Product NO. DOSIN-809-0045	REV A	
DateTime 2015/12/24	CAD FILE H/company drawings/BD	SHEET: 1 OF 1	

1	Body	Brass	Au: lu
2	Insulator	TEFLON	White
3	Center contact	Phosphor	Au: 3u
NO	Component Number	Material	Finish